

1950  
• SINCE •



# iPlasma

PLASMA-OXY CUTTING





# 1950

MVD produced its first machine .



# 1971

The first sheet metal working machine “perforation press” was presented to the market.

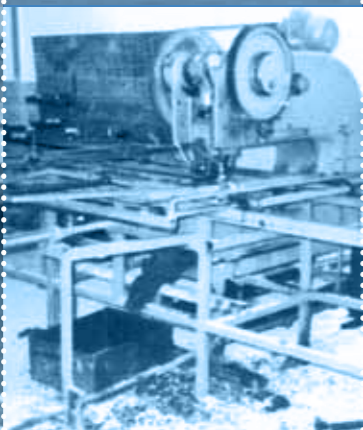

# 1974

The production of “Heavy-duty Press Brakes and Guillotine Shears” started and MVD had the distinction of being the first Turkish manufacturer for heavy press brakes and shears.



# 1981

Moved to second factory and added the production of 4 roll bending machines and Expanded Metal presses in the next years. Thus, a great variety of machines were presented in sheet metal working industry.



# 1994

MVD produced the first tandem press brake in Turkey.

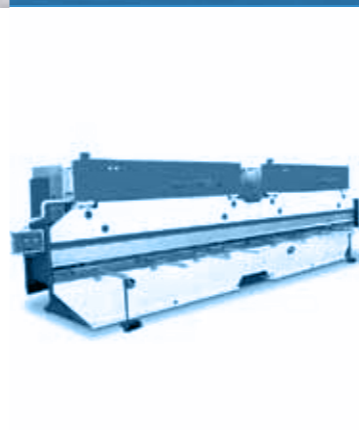

# 2001

Finalised the CE conformity procedures and had its machines CE marked.



# 2003

CNC Hydraulic Turret Punch machine was presented to the market.

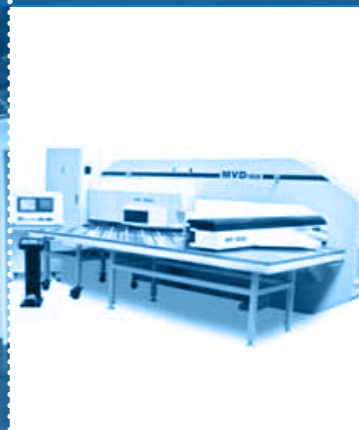

# 2011

Plasma cutting machine and Fiber Laser Cutting machines were presented to the market.







## Quality High Technology

**Quality and service support is accepted as principle. Designing and manufacturing are based on reliability, durability and precision.**

Machines are easy to use and are built to be ready for user errors. Machines are designed and analyzed with 3-D supported computer aided programs, precisely machined in moving column CNC machining centres, equipped with world-known equipments and presented to the customers' use after quality control.





# iPlasma A Series

PLASMA-OXY CUTTING



## General Features

- ▶ A Series design for High Performance ,High Agility ,High Speed Cutting and Accuracy , A series can configure Plasma ,Plasma –Oxy Fuel , Multi Plasma options.

## Standard Equipments

- ▶ Hypertherm Max 200
- ▶ Automatically Height ARC Contoller
- ▶ ESA CNC Control Unit
- ▶ ESA CAD/CAM software , Nesting ( dxf ve dwg convert )
- ▶ Hypertherm Manual Gas control Console
- ▶ Double Side driven rigit gantry system
- ▶ AC servo motorized driven without backlash gear box ,high accuracy rack and pinion , linear guide sytem
- ▶ Automatically , zone section extraction system for fume by pneumatic covers

## Optional Equipments

- ▶ Hypertherm HSD130
- ▶ Hypertherm HPR130
- ▶ Hypertherm HPR260
- ▶ Kjellberg Hi Focus 130i
- ▶ Kjellberg Hi Focus 280i
- ▶ Hypertherm Tru –Hole Technology for hole diamater to thckness of material
- ▶ Kjellberg Contour-Cut Technology for hole diamater to thckness of material
- ▶ Automatic Gas Console
- ▶ Tanaka OXY Torch
- ▶ Messer OXY Torch
- ▶ LANTEK CAD/CAM software , Nesting
- ▶ IHT Height control unit
- ▶ Multi Plasma , double or Tribble Plasma Torch
- ▶ Filter Unit for Fume
- ▶ Spare part starting Kits

### ▶ Plasma Unit



▶ Hypertherm Max 200  
Standard

▶ Hypertherm HSD130  
Optional

▶ Hypertherm HPR130  
Optional

▶ Hypertherm HPR260  
Optional

▶ Kjellberg HiFocus 130i  
Optional

Equipments



▶ ESA s510 CNC Control Unit



▶ Lantek CAD/CAM software Automatic Nesting

Equipments



▶ Kjellberg Contour Cut

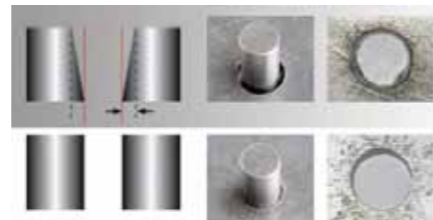

▶ Hypetherm True Hole

Cutting Capacity

	Mild Steel	Stainless Steel	Aluminium	ISO 9013 Cutting Angle
<b>HYPERTHERM MAX 200</b>				
Clean Cut	25mm	25mm	25mm	4 -5 Degree
Piercing	25mm	25mm	25mm	
Edge Cut	50mm	50mm	50mm	
<b>HYPERTHERM HSD 130</b>				
Clean Cut	16mm	-	-	4 Degree
Piercing	25mm	20mm	20mm	
Edge Cut	38mm	25mm	25mm	
<b>HYPERTHERM HPR 130 XD</b>				
Clean Cut	16mm	-	-	2 - 4 Degree
Piercing	32mm	20mm	20mm	
Edge Cut	38mm	25mm	25mm	
<b>HYPERTHERM HPR 260 XD</b>				
Clean Cut	32mm	-	-	2 - 4 Degree
Piercing	38mm	32mm	25mm	
Edge Cut	64mm	50mm	50mm	
<b>KJELLBERG HI FOCUS 130I</b>				
Clean Cut	10mm	-	-	2-4 Degree
Piercing	25mm	15mm	20mm	
Edge Cut	40mm	20mm	25mm	
<b>KJELLBERG HI FOCUS 280I</b>				
Clean Cut	35mm	-	-	2-4 Degree
Piercing	40mm	30mm	25mm	
Edge Cut	70mm	70mm	70mm	

Material thickness, hole diameter technology options  
 Countour cut for Kjellberg provides high accuracy quality 2 degree ISO9013  
 True hole technology for Hypertherm provides high accuracy quality 2 degree ISO9013

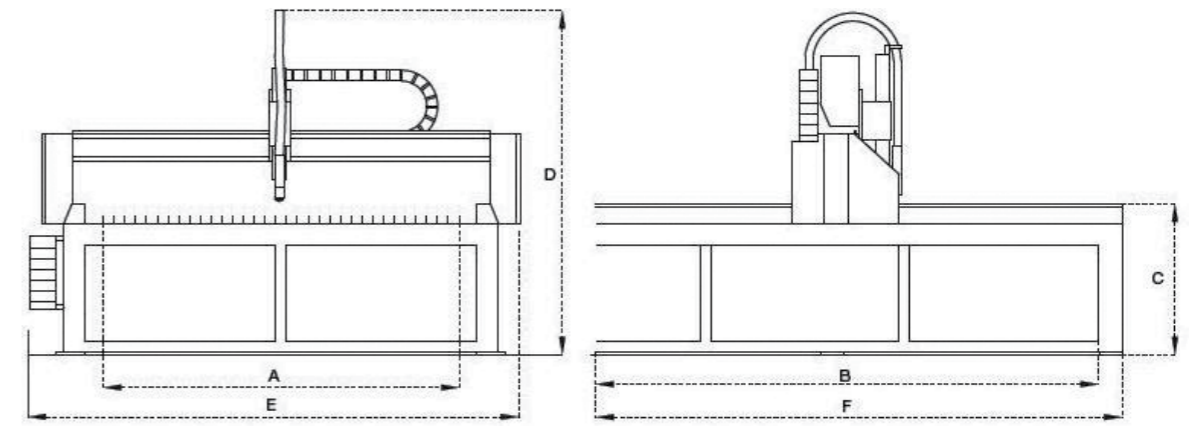

Technical Table

iPlasma A Series	Cutting Width	Cutting Length	Table Height	Height	Width	Length
	A	B	C	D	E	F
	mm	mm	mm	mm	mm	mm
A 1500-3000	1550	3150	750	2000	2850	4900
A 2000-4000	2100	4200	750	2000	3250	6000
A 2000-6000	2100	6200	750	2000	3250	8000
A 3000-6000	3200	6200	750	2000	4250	8000
A 3000-12000	3200	12300	750	2000	4250	14000

Technical specifications are subject to change without notice. Special capacity machines can be manufactured upon request.



▶ Multi Plasma Options



▶ Filter Unit



▶ Automatic Height Control



# iPlasma B Series

PLASMA-OXY CUTTING

## Standard Equipments

- ▶ Hypertherm Max 200
- ▶ Automatically Height ARC Contoller
- ▶ ESA CNC Control Unit
- ▶ ESA CAD/CAM software , Nesting (dxf ve dwg convert )
- ▶ Hypertherm Manual Gas control Console
- ▶ Double Side driven suitable for Heavy Duty thicker material cutting gantry system with rails
- ▶ AC servo motorized driven without backlash gear box
- ▶ Automatically , zone section extraction system for fume by pneumatic covers

## Optional Equipments

- ▶ Hypertherm HSD130
- ▶ Hypertherm HPR130
- ▶ Hypertherm HPR260
- ▶ Hypertherm HPR400
- ▶ Kjellberg Hi Focus 130i
- ▶ Kjellberg Hi Focus 280i
- ▶ Kjellberg Hi Focus 360i
- ▶ Hypertherm Tru –Hole Technology for hole diamater to thckness of material
- ▶ Kjellberg Contour-Cut Technology for hole diamater to thckness of material
- ▶ Automatic Gas Console
- ▶ Tanaka OXY Torch
- ▶ Messer OXY Torch
- ▶ Automatic OXY ignitions system
- ▶ LANTEK CAD/CAM software , Nesting
- ▶ IHT Height control unit
- ▶ Multi Plasma , double or Tribble Plasma Torch
- ▶ Double Gantry ,Bridge
- ▶ Filter Unit for Fume
- ▶ Spare part starting Kits

## General Features

- ▶ B Series Industrial Plasma Cutting Machine design for Heavy Duty plasma –OXY cutting applications  
B series machine can configure with Multi Plasma, OXY-Plasma , Double Gantry options

### ▶ Plasma Unit



▶ Hypertherm Max 200  
Standard

▶ Hypertherm HSD130  
Optional

▶ Hypertherm HPR130  
Optional

▶ Hypertherm HPR260  
Optional

▶ Kjellberg HiFocus 130i  
Optional



Equipments



ESA s510 CNC Control Unit



Lantek CAD/CAM software Automatic Nesting

Equipments



Kjellberg Contour Cut

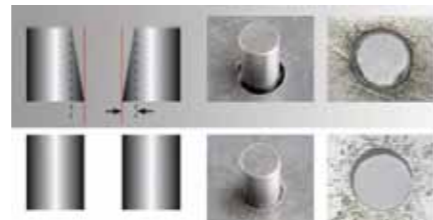

Hypetherm True Hole

Cutting Capacity

	Mild Steel	Stainless Steel	Aluminium	ISO 9013 Cutting Angle
<b>HYPER THERM MAX 200</b>				
Clean Cut	25mm	25mm	25mm	4 - 5 Degree
Piercing	25mm	25mm	25mm	
Edge Cut	50mm	50mm	50mm	
<b>HYPER THERM HSD 130</b>				
Clean Cut	16mm	-	-	4 Degree
Piercing	25mm	20mm	20mm	
Edge Cut	38mm	25mm	25mm	
<b>HYPER THERM HPR 130 XD</b>				
Clean Cut	16mm	-	-	2 - 4 Degree
Piercing	32mm	20mm	20mm	
Edge Cut	38mm	25mm	25mm	
<b>HYPER THERM HPR 260 XD</b>				
Clean Cut	32mm	-	-	2 - 4 Degree
Piercing	38mm	32mm	25mm	
Edge Cut	64mm	50mm	50mm	
<b>KJELLBERG Hi Focus 130i</b>				
Clean Cut	10mm	-	-	2-4 Degree
Piercing	25mm	15mm	20mm	
Edge Cut	40mm	20mm	25mm	
<b>KJELLBERG Hi Focus 280i</b>				
Clean Cut	35mm	-	-	2-4 Degree
Piercing	40mm	30mm	25mm	
Edge Cut	70mm	70mm	70mm	
<b>KJELLBERG Hi Focus 360i</b>				
Clean Cut	35mm	-	-	2-4 Degree
Piercing	50mm	40mm	40mm	
Edge Cut	80mm	80mm	80mm	

Material thickness, hole diameter technology options  
 Countour cut for Kjellberg provides high accuracy quality 2 degree ISO9013  
 True hole technology for Hypertherm provides high accuracy quality 2 degree ISO9013

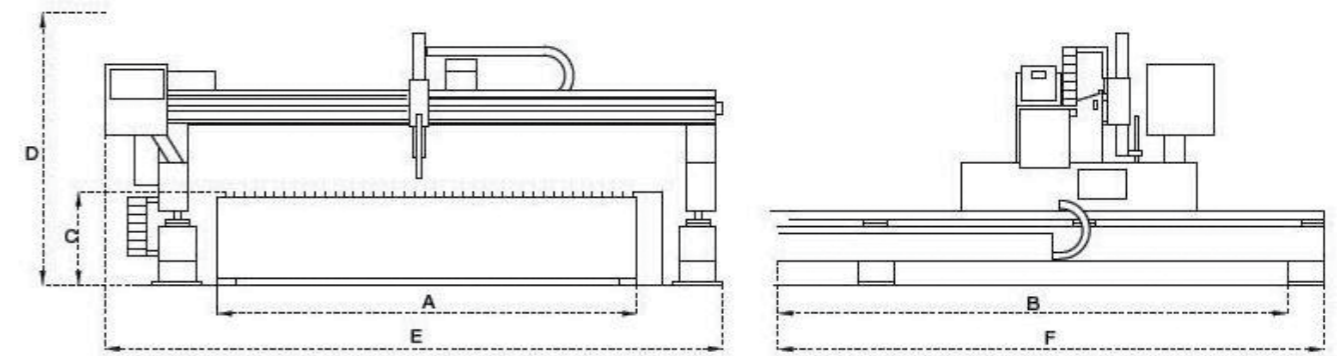

Technical Table

iPlasma B Series	Cutting Width	Cutting Length	Table Height	Height	Width	Length
	A	B	C	D	E	F
	mm	mm	mm	mm	mm	mm
B 3000-6000	3100	6200	750	2000	4700	8000
B 3000-8000	3100	8200	750	2000	4700	10000
B 3000-12000	3100	12200	750	2000	4700	14000
B 4000-8000	4200	8200	750	2000	5700	10000
B 4000-12000	4200	12200	750	2000	5700	14000
B 4000-16000	4200	16200	750	2000	5700	18000

Technical specifications are subject to change without notice. Special capacity machines can be manufactured upon request.



Multi Plasma Options



Filter Unit



Automatic Height Control

www.mvd.com.tr



### MVD İnan Takım Tezgahları Sanayi A.Ş.

**ADRESS** : Konya Organize Sanayi Bölgesi Evrenköy Cad.  
1 Nolu Sokak No: 3 42050 Konya / Türkiye

**TELEPHONE** : +90 332 239 22 33 (pbx)

**FAX** : +90 332 239 21 21

**GPS** : 37° 58' 59" N, 32° 36' 34" E

**WEB** : www.mvd.com.tr

**E-MAIL** : info@mvd.com.tr